

RDC Resilient Dust Cap Series

CT10309

CTI's new line of resilient dust caps provide a high level of sealing for both plugs and receptacles. The thermoplastic elastomer (TPE) material provides excellent UV stability and chemical and oil resistance. The caps come fastened with a durable stainless steel Nylon coated lanyard.

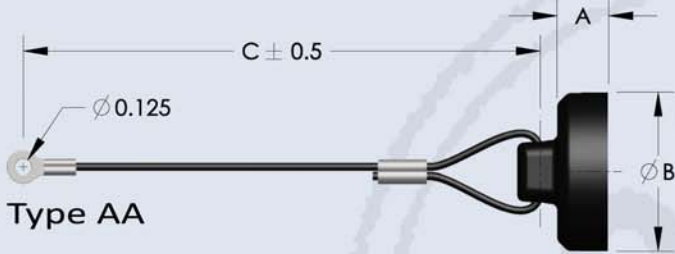

PART NO	CAP, RECEPTACLE		
	DIMENSION		
	A	Ø B	C
08	0.40	0.70	3.0
10	0.40	0.82	3.0
12	0.40	0.98	3.5
14	0.40	1.11	3.5
16	0.40	1.24	3.5
18	0.40	1.36	3.5
20	0.40	1.48	4.0
22	0.40	1.61	4.0
24	0.40	1.74	4.0

Dimensions in inches

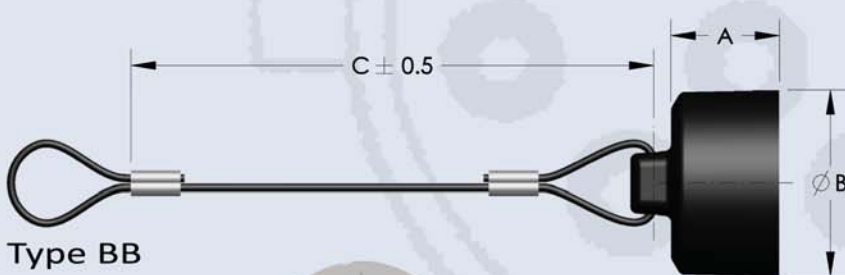

PART NO	CAP, PLUG		
	DIMENSION		
	A	Ø B	C
08	0.83	0.89	3.0
10	0.83	1.00	3.0
12	0.83	1.17	3.5
14	0.83	1.30	3.5
16	0.83	1.42	3.5
18	0.83	1.53	3.5
20	0.90	1.67	4.0
22	0.90	1.79	4.0
24	0.960	1.92	4.0

Dimensions in inches

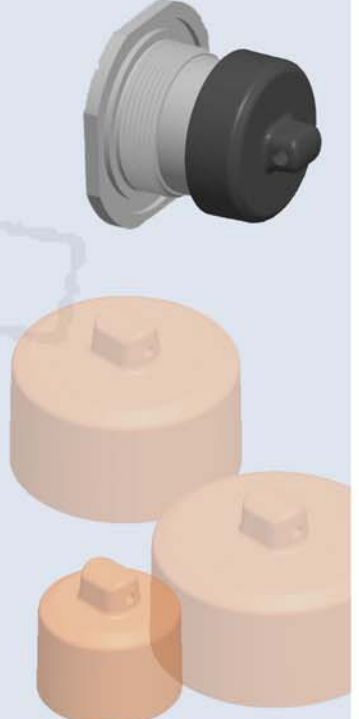
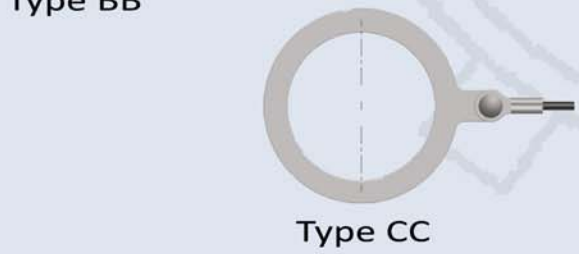

Product Series **RDC** 8 P - 12 AA

Connector Series

8 - MIL-DTL-26482 (Souriau 851 series)

9 - MIL-DTL-38999

5 - MIL-C-5015

P - Plug R - Receptacle

Size

Attachment Type

Color (omit for standard Black, other colors available)

Lanyard Length in inches (if other than standard)

info@connectech.com

www.connectech.com

5 Walter Foran Blvd. Suite 4005
 Flemington, New Jersey 08822
 Phone (800) 458-5646
 Fax (732) 828-9142



135 Industry Court
 Kalispell, Montana 59901
 Phone (888) 646-7278
 Fax (406) 756-0775